

Kod produktu	Width [mm]	Height [mm]	Depth from wall [mm]	Connections spacing [mm]	Connections distance from the wall [mm]	Brackets spacing [mm]	Heating surface [m ²]	Weight [kg]	Capacity [dm ³]	Power $\Delta T=50K$ (75/65/20 °C) [W]	Power $\Delta T=46K$ (75/65/24 °C) [W]	Power $\Delta T=30K$ (55/45/20 °C) [W]	Electric heater maximum power [W]
	W	H	D	C	B	A							
MS00420180014P081000	420	1800	85	50	70	1690	2,16	29,1	16,8	833	747	426	600
MS00420200014P081000	420	2000	85	50	70	1890	2,40	32,1	18,6	923	827	469	900
MS00516180014P081000	516	1800	85	50	70	1690	2,69	35,9	21,0	1037	930	531	900
MS00516200014P081000	516	2000	85	50	70	1890	2,98	39,5	23,1	1149	1029	584	900
MS00615180014P081000	615	1800	85	50	70	1690	3,22	42,7	24,9	1239	1111	634	900
MS00615200014P081000	615	2000	85	50	70	1890	3,56	45,9	27,5	1372	1229	698	900

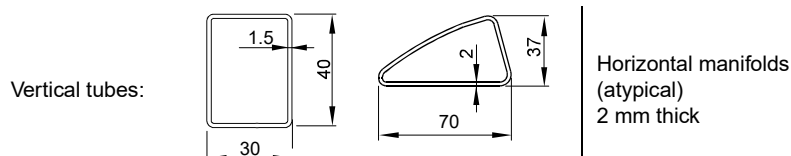

Finishing and warranty:	Cataphoresis + polyester-epoxy lacquer; 5 year warranty;
Mounting brackets:	set for assembly on the wall; brackets in the colour of a towel rail
Valve:	order separately
Heater:	order separately
Working pressure:	4 bars
Maximum temperature:	120 °C
Connections:	 inner threads G 1/2 air-vent plug G 1/2 screwed in the upper hole of the collector, included
Accessories:	order separately

